

Wizard CompSpec C2 Assembly Instructions



Parts Needed

Truck assembly from previous steps

Bag I

- (1) part# ott-tko10-077 Wizard TKO-10 Front Straight Axle Assembly x1
or ott-tko10-074 Wizard TKO-10 Front Portal Axle Assembly x1
- (2) part# ott-tko10-083 M3 x 0.5 x 16mm button head screw x1
- (3) part# ott-tko10-085 M3 x 0.5 x 25mm button head screw x2

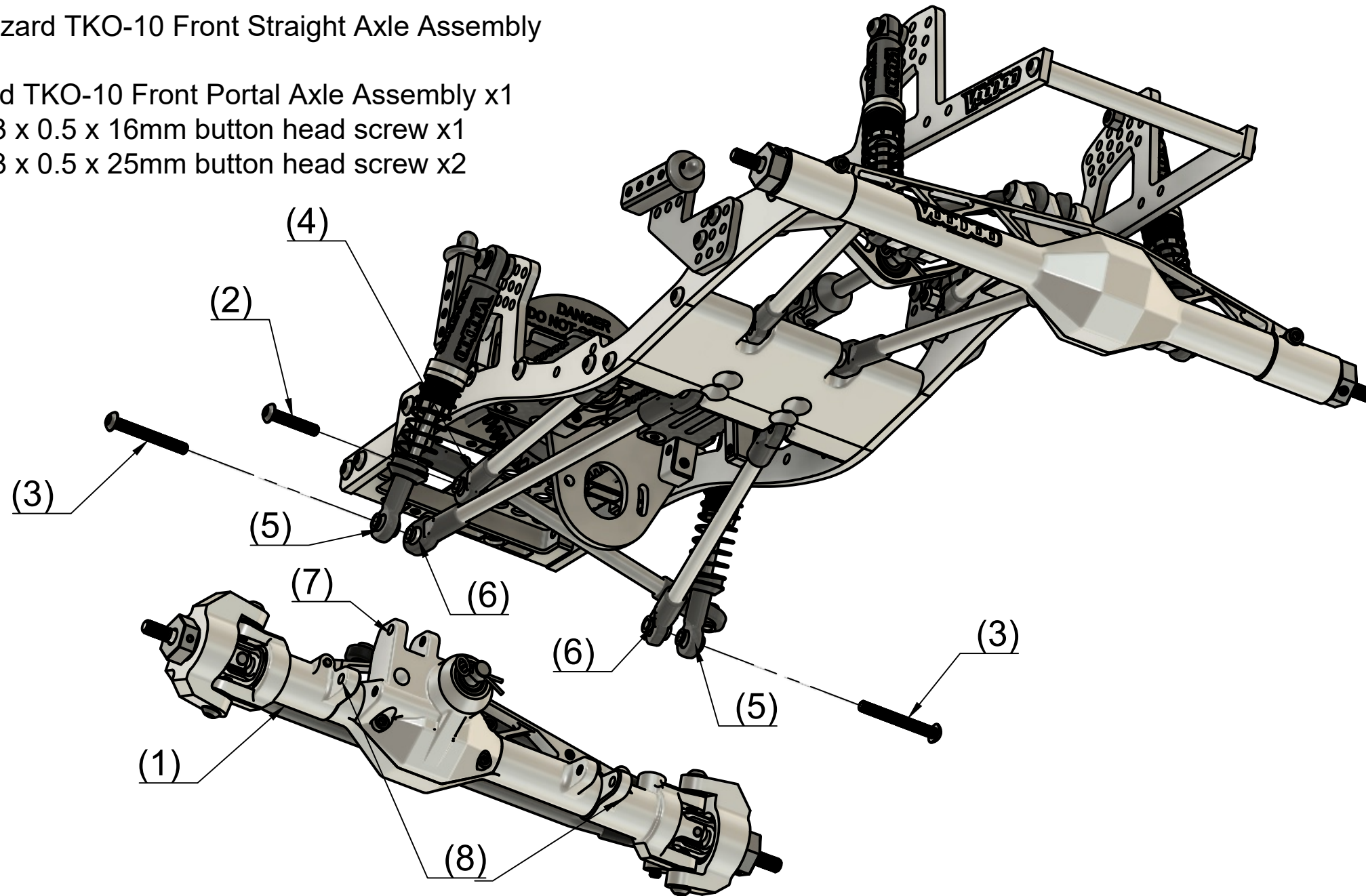

Step 31

blue threadlock is recommended on all threads

Insert M3 x 0.5 x 16mm button head screw (2) through upper link mount on front axle assembly (7) then tighten completely

Insert M3 x 0.5 x 25mm button head screw (3) through shock (5), lower link mount on front axle assembly (8), and Front Lower Link (6) then tighten completely

